

Attach the triangle roof to the shop as shown:

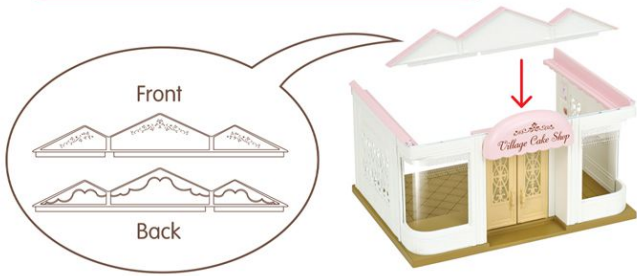

Attach the whisk and palette knife to the wall



Apply the stickers to the shop and toppers as shown:



Insert the strawberries, chocolate and toppers into the holes in the pastries as shown



Assemble the cake boxes as shown:

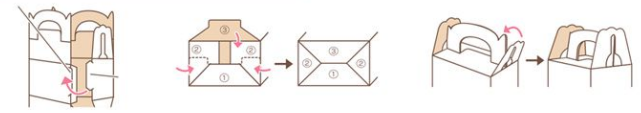

Create the 3 tier cake as shown. Insert the bow into the hole in the cake

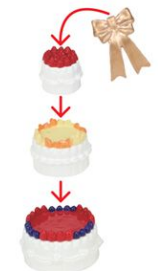

Assemble the gift boxes as shown:



Attach the showcase to the display table or use the showcase as another table



Place a cake on the turntable and spin



Place a doily and cake on each stand



Place doilies and cakes on the display table